

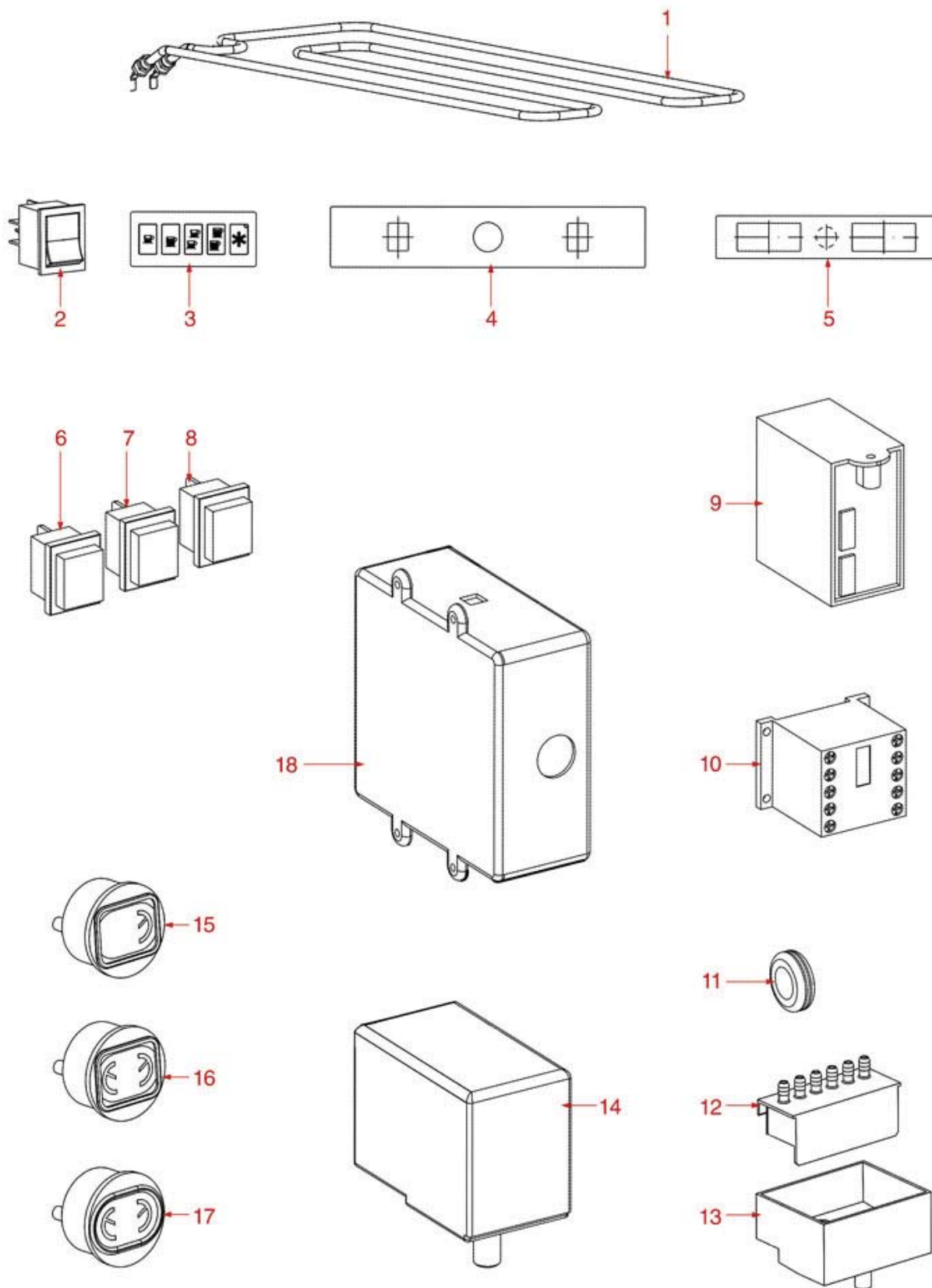

ELECTRICAL PARTS & MISCELL.BART-CAFE-PUB

**BART-CAFE-PUB**





# PAVONI



Position	LF code no.	Description
2	3319934	ORANGE BIPOLAR SWITCH 16A 250V
3	1319316	PUSH-BUTTON PANEL MEMBRANE 5 BUTTONS
6	3319012	GREEN BIPOLAR SWITCH 16A 250V
7	3319090	GREEN BIPOLAR SWITCH 16A 250V
9	1341301	LEVEL ADJUSTER NRL30/1E-2C/F 230V
13	1527537	DRAIN TRAY
14	1320531	PRESSURE SWITCH P302/6 3-POLES 30A
15	1245800	BOILER PRESSURE GAUGE ø 63 mm 0÷2.5 bar
16	1245801	BOILER-PUMP PRESSURE GAUGE ø 63 mm
17	1245802	BOILER-PUMP PRESSURE GAUGE ø 63 mm
18	1054022	DOSER CONTROL BOX 2 GROUPS 230V