

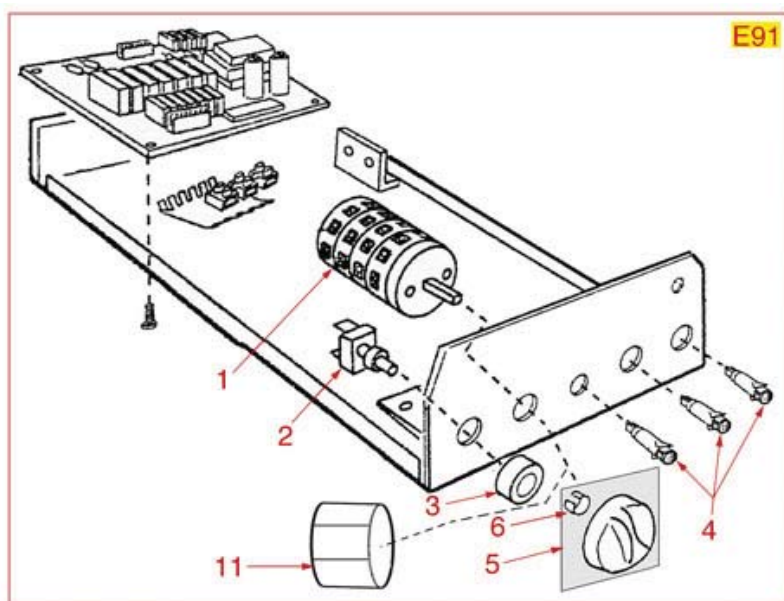

ELECTRICAL PARTS

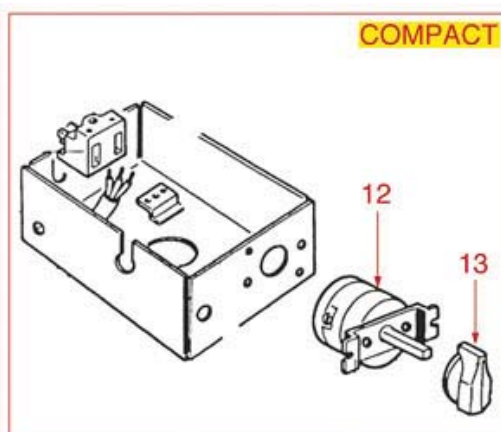

E91



COMPACT

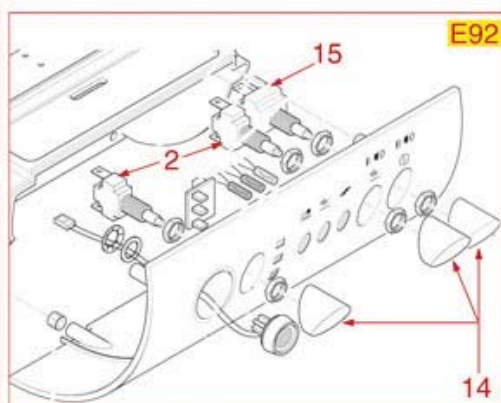

E92

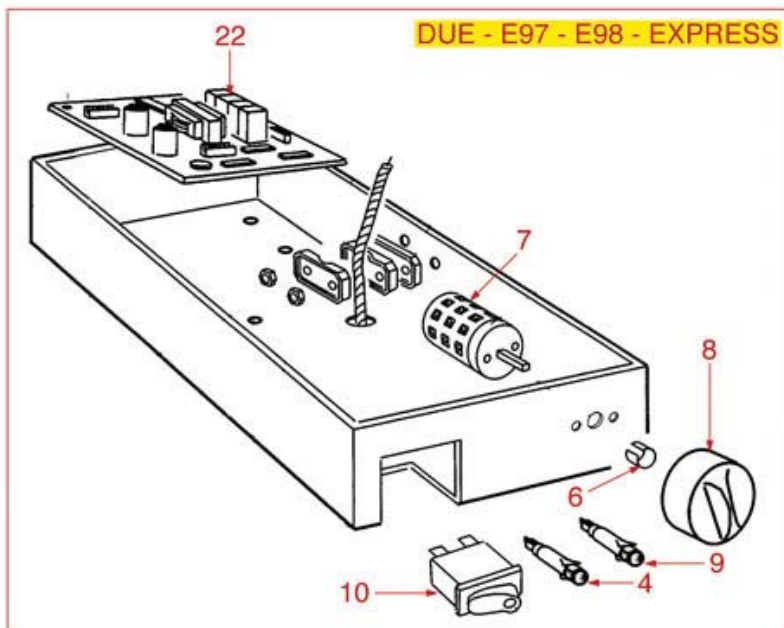

DUE - E97 - E98 - EXPRESS



E61 - E98 COMPACT

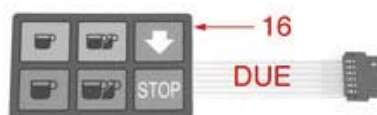
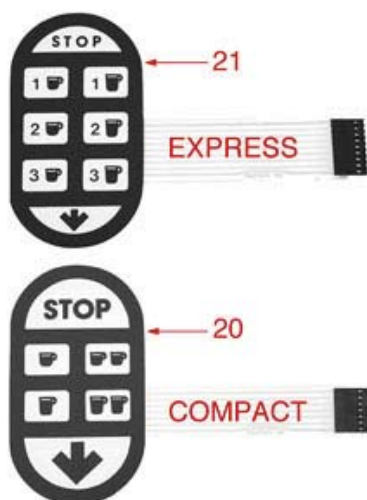

DUE

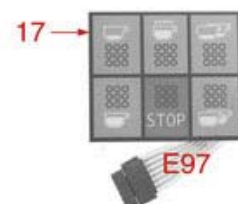

E97

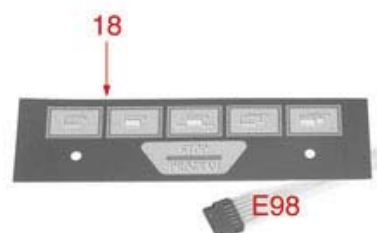

E98



DUE



FAEMA



Position	LF code no.	Description
1	1057004	SELECTOR SWITCH 0-2 POSITIONS 20A 600V
2	1319052	BIPOLAR SWITCH 16A 250V
3	1241317	SWITCH BUTTON F.CUP WARMER
4	1221111	RED INDICATOR LAMP 220V
4	1221112	GREEN INDICATOR LAMP 250V
5	1241318	SELECTOR SWITCH KNOB
6	3241084	ELASTIC RING FOR KNOB
7	1057004	SELECTOR SWITCH 0-2 POSITIONS 20A 600V
8	1241033	SELECTOR SWITCH KNOB ø 40 mm
9	3221101	GREEN INDICATOR LAMP 230V
11	1241040	SELECTOR SWITCH KNOB ø 31 mm
12	3059014	SELECTOR SWITCH 0-1 POSITIONS 20A 500V
13	1241542	BLACK KNOB FOR CONVERTER
14	1319097	SWITCH BUTTON
15	1319098	BIPOLAR SWITCH 16A 250V
16	1319503	PUSH-BUTTON PANEL MEMBRANE 6 BUTTONS
17	1319020	PUSH-BUTTON PANEL MEMBRANE 6 BUTTONS
18	1319022	PUSH-BUTTON PANEL MEMBRANE 6 BUTTONS
19	1319051	PUSH-BUTTON PANEL MEMBRANE 6 BUTTONS
20	1319501	PUSH-BUTTON PANEL MEMBRANE 6 BUTTONS
21	1319502	PUSH-BUTTON PANEL MEMBRANE 8 BUTTONS
22	1390001	LEVEL ELECTRONIC BOARD
30	1739002	TOROIDAL TRANSFORMER 240V 50/60Hz