

# Repair Parts List

MODEL NUMBER

RC520SC2

MANUFACTURING  
NUMBER

P1332839M

## COMMERCIAL MICROWAVE

When requesting service or ordering parts, always  
provide the following information:

- Product Type
- Part Number
- Model Number
- Part Description

***Amana***<sup>®</sup>  
HIGH PERFORMANCE HAS A NAME™

PART OF  FOODSERVICE GROUP

December 15 2006

Section: TRAY, GREASE SHIELD, CABINET,

Model: RC520SC2\_P1332839M

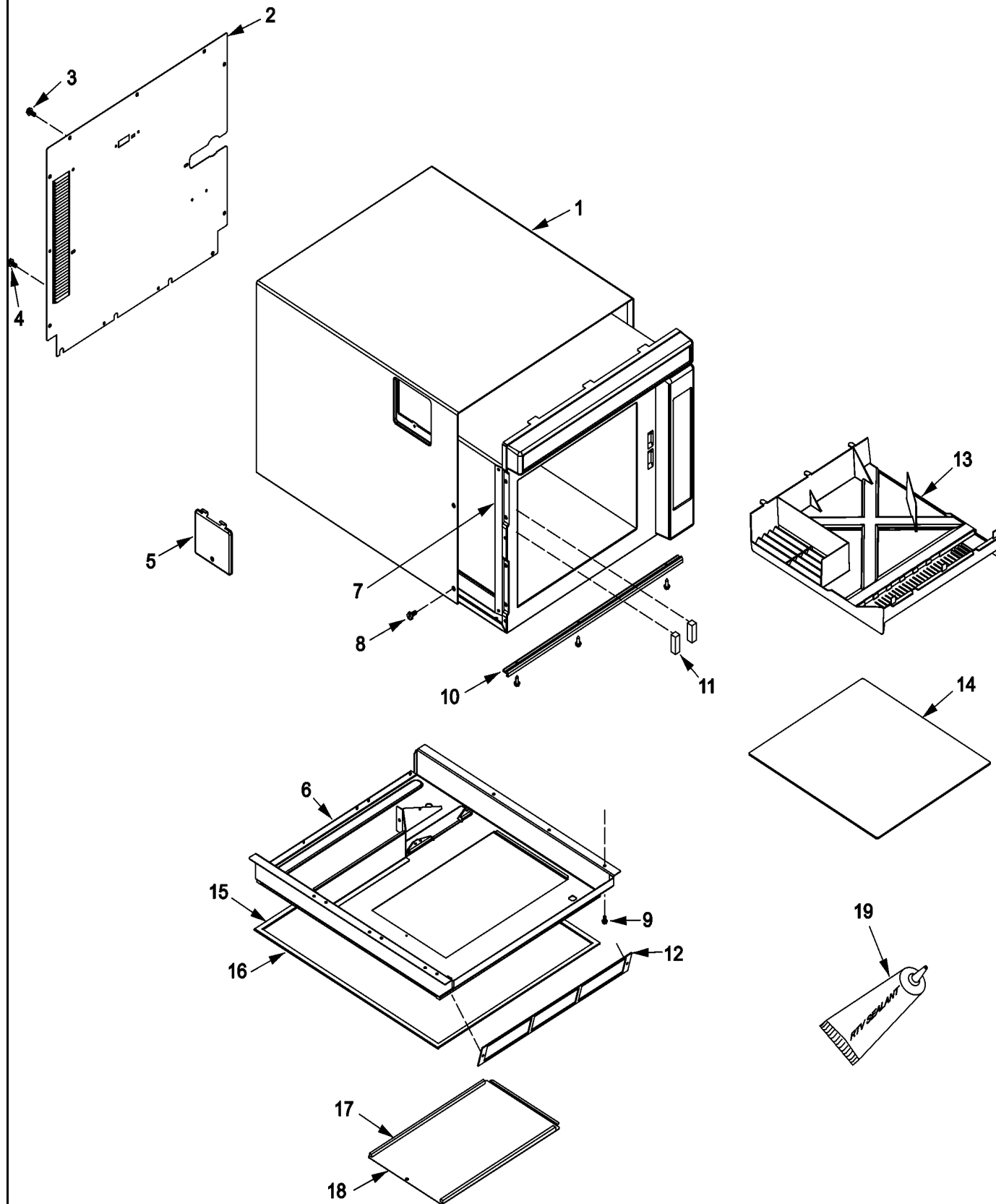

## Section: TRAY, GREASE SHIELD, CABINET,

No.	Part No.	Description	Series Qty
1	10908901Q	WRAPPER-OC (SS)	1
2	R0156970	ASSY, ACCESS PANEL (REAR)	1
3	13042101	SCREW-TC/Y	8
4	12990525	SCREW-SM/HEX	3
5	10785608	COVER LIGHT (SS)	1
-	13042002	SCREW-TF/OVAL	1
-	M0288215	NUT-SPEED	1
6	59001130	ASSY, BASE PAN	1
7	12189003	BRACKET,HINGE SUPPORT	1
-	59002047	SCREW-TF/HEX ROHS	2
8	13042002	SCREW-TF/OVAL	4
9	67007110	SCREW	6
-	13042002	SCREW-TF/OVAL	3
10	10909005	TRIM-OC	1
11	3010003001	SUPPORT-TRAY	2
-	M0274066	WASHER, NYLON	2
-	13042901	SCREW-THUMB	2
12	10853102	GRILLE, AIR INLET	1
13	10766601	SHIELD, GREASE	1
14	R0156942	TRAY-CERAMIC FLOOR W/SEALER	1
15	R0000413	GASKET,BASEPAN	2
16	R0000413	GASKET,BASEPAN	2
17	A3030330	GASKET,PER FT	2
18	10782402	BOTTOM ACCESS PANEL	1
-	12990527	SCREW-SM/HEX	1
19	M0275598	SEALER	1

Section: DOOR

Model: RC520SC2\_P1332839M

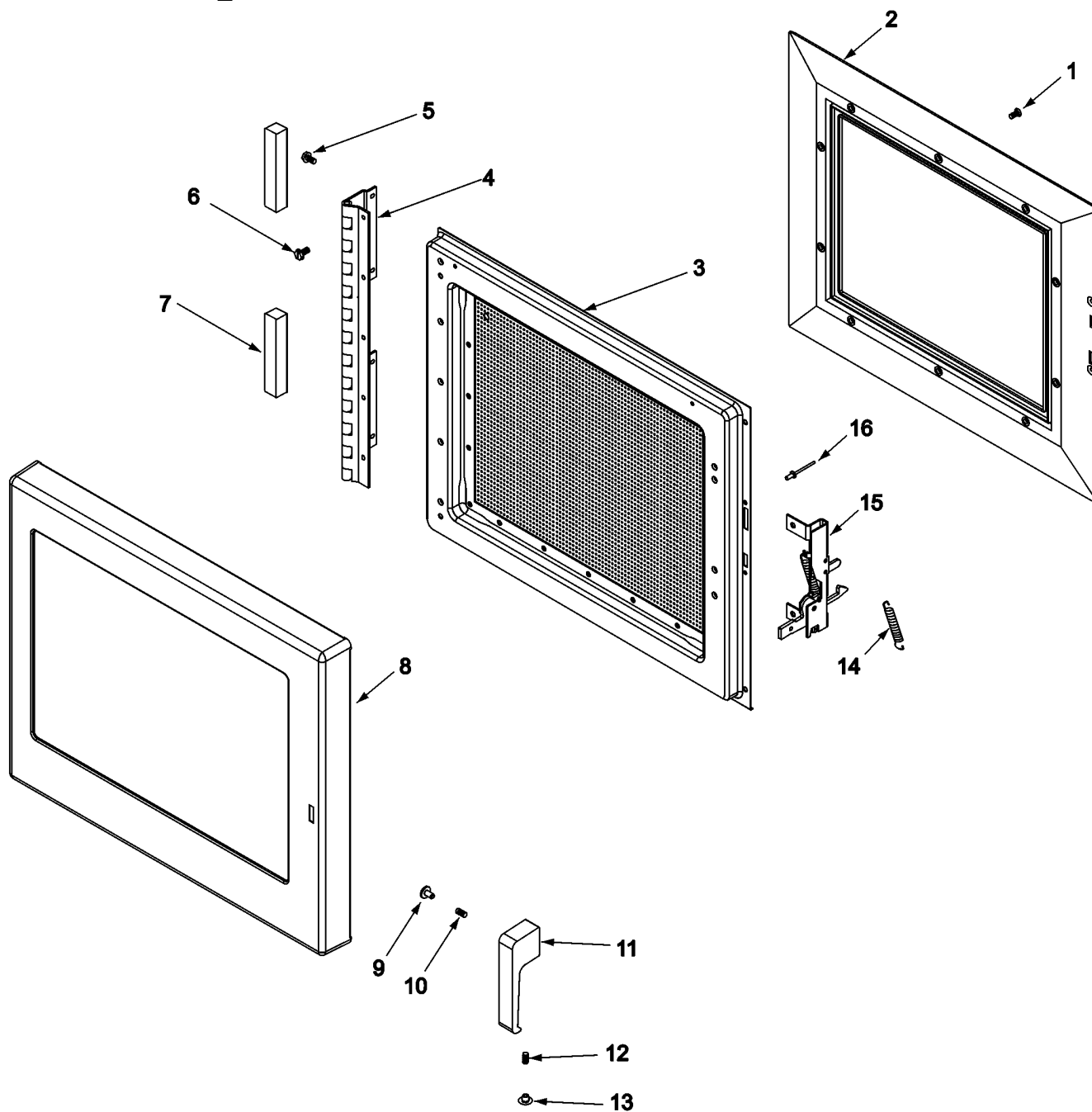

## Section: DOOR

No.	Part No.	Description	Series Qty
1	67003392	SCREW-HI LO Y-DRIVE HEAD	10
-	R0193574	MAGNETIC Y-DRIVE BIT	1
2	59002015	DOOR, INNER	1
3	59002013	DOOR RING WELD	1
4	C8961811	HINGE-DOOR	1
5	M0216716	SCREW	4
6	12990527	SCREW-SM/HEX	5
7	A3263904	GASKET	2
8	R0156918	OUTER DOOR/LENS RETAINER ASSY	1
9	12360703	PLUG, BUTTON (BLK) Note: PLUG, BUTTON (BLK) (SIDE)	1
10	13046901	SCREW-SET/CONE	1
11	12490901	HANDLE, DOOR	1
12	13047001	SCREW-SET/DOG	1
13	M0310305	PLUG, BUTTON (WHT)	1
14	C8893502	SPRING, DOOR LATCH	1
15	12002757	LATCH KIT- RC CHASSIS	1
16	59002054	RIVET-POP	2

**Model: RC520SC2\_P1332839M**



## Section: ANTENNAS, BLOWER, DUCTS,

No.	Part No.	Description	Series Qty
-	59002047	SCREW-TF/HEX ROHS	6
1	R0130263	MOTOR-ANTENNA STIRRER (230V)	2
2	59001205	SHAFT, RET-GEAR	2
3	12570101	GEAR,SPUR	4
4	10903002	WASHER. SPUR GEAR	2
5	10781901	DUCT, EXHAUST	1
6	B8367701	WINDOW, OVEN LIGHT	2
7	R0130262	ANTENNA (STIRRER)	2
8	67007110	SCREW	5
9	10966601	GASKET, NEOPRENE	1
10	A3030330	GASKET,PER FT	9
11	59001204	PANEL, PARTITION	1
-	12990525	SCREW-SM/HEX	2
12	R0156984	TOP EXHAUST DUCT-W/GASKET	1
13	A3030330	GASKET,PER FT	3
14	R0156985	BOTTOM EXHAUST DUCT-W/GASKET	1
-	12990525	SCREW-SM/HEX	2
15	A3030311	GASKET-PER INCH	1
16	R0156987	BOTTOM DIVIDER DUCT-W/GASKET	1
17	R0156986	REAR DIVIDER DUCT-W/GASKET	1
-	12990522	SCREW-SM/HEX	3
18	A3030330	GASKET,PER FT	1
19	59002047	SCREW-TF/HEX ROHS	4
20	B5706704	FAN BLADE	1
21	59001482	MOTOR, BLOWER	1
-	12990522	SCREW-SM/HEX	3
22	59001483	BRACKET,BLOWER	1
23	13033801	CORD-POWER	1
24	M0370009	RELIEF- STRAIN	1
25	B5677203	TERMINAL BLOCK	1
-	M0234117	SCREW	1
-	M0216517	SCREW	4
26	12552001	SCROLL,BLOWER	1
27	A3030330	GASKET,PER FT	2
28	C3670809	WHEEL, BLOWER	1
29	10091101	FUSE HOLDER	1
30	M0805205	FUSE- 30A	1
-	M0216517	SCREW	2
31	59001496	LINE FILTER	1

# Section: ELECTRICAL COMPONENTS

Model: RC520SC2\_P1332839M

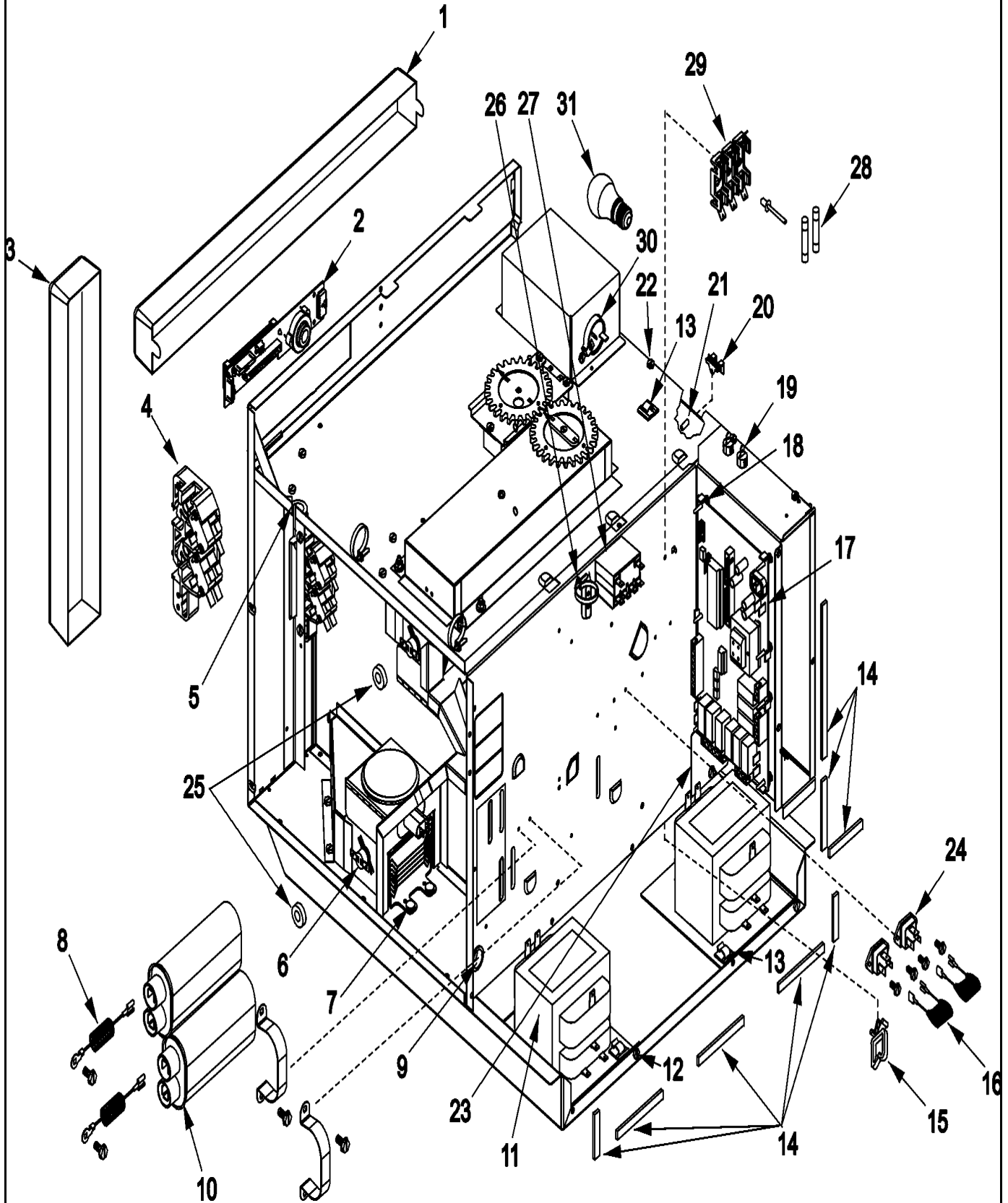

## Section: ELECTRICAL COMPONENTS

No.	Part No.	Description	Series Qty
-	59002047	SCREW-TF/HEX ROHS	2
1	59001859	TOUCH PANEL(TOP)	1
-	13042002	SCREW-TF/OVAL	3
2	12502404	BOARD,DISPLAY	1
-	59002047	SCREW-TF/HEX ROHS	2
3	R0130109	TOUCH PANEL(SIDE)	1
-	59001952	SCREW	2
4	12002636	SWITCH, INTERLOCK KIT	1
5	A3293505	BUSHING-SNAP	1
-	M0229916	SCREW T.C	4
6	59001564	THERMAL CUTOUT	2
7	59001862	MAGNETRON-T	2
-	12990522	SCREW-SM/HEX	2
8	B8383102	RECTIFIER	2
9	59001128	BUSHING, SNAP	1
-	12990522	SCREW-SM/HEX	4
10	59001170	CAPACITOR-1.15	2
-	A4055405	STRAP, CAPACITOR	2
11	10788622	TRANSFORMER-HV 230V 50 HZ	2
12	12990525	SCREW-SM/HEX	2
13	M0104106	CLIP	3
14	A3030330	GASKET,PER FT	8
15	B5667304	WIRE CLIP	1
16	59002017	SNUBBER ASSEMBLY	2
17	12559142	HV BD-AMANA PROG	1
18	M0590602	SUPPORT P-C BD A	7
19	M0325401	BUSHING,TERMINAL	2
20	59001564	THERMAL CUTOUT	1
-	M0229916	SCREW T.C	1
21	M0308801	CAP, PROTECTIVE-THREADED (RED)	1
22	59002047	SCREW-TF/HEX ROHS	4
-	67007110	SCREW	3
23	59001204	PANEL, PARTITION	1
24	R0157373	KIT, TRIAC ASSY	2
-	12990522	SCREW-SM/HEX	4
25	44780P01	TOROID (ARC SUPPRESSOR)	2
26	M0322202	TIE WIRE	3
27	59001981	RELAY	1
28	M0805102	FUSE 15 AMP	2
-	59002054	RIVET-POP	1
29	12136502	BLOCK-3 POLE FUSE	1
30	B8376801	SOCKET, LIGHT	1
-	59002047	SCREW-TF/HEX ROHS	1
31	67002552	BULB, LIGHT (40W-250V)	1

## Section: SUPPLEMENTAL INFORMATION

No.	Part No.	Description	Series Qty
1	16022149	SVC MAN, INTL COMM MICRO	1
2	59001488	USE & CARE-AMANA COM MICROWAVE	1
3	N 16027608	TECH SHT, COMM MICRO	1
4	N 12834601	INSTRUCTIONS, QUICK START	1
5	13062001	MANUAL-PROD SAFETY	1
6	R0193574	MAGNETIC Y-DRIVE BIT	1
7	R0130265	HARNESS, HV BOARD TO DISPLAY	1
8	13018201	HARNESS-INTERLOCK	1
9	13018701	HARNESS-OVEN LT	1
10	13018801	HARNESS-LW ANT MOTOR	1
11	13019201	HARNESS-OVEN	1
12	13019001	HARNESS-HI VOLT	1
13	12002483	KIT-CAV- 2 TUBE "S" CHASSIS	1

## Section: WIRING INFORMATION

Model: RC520SC2\_P1332839M

SCHEMATIC CONDITION: DOOR OPEN

230-240V 50Hz 3-WIRE

