

ELECTRIC EQUIPMENT/PUSH BUTTONS 100-105

105

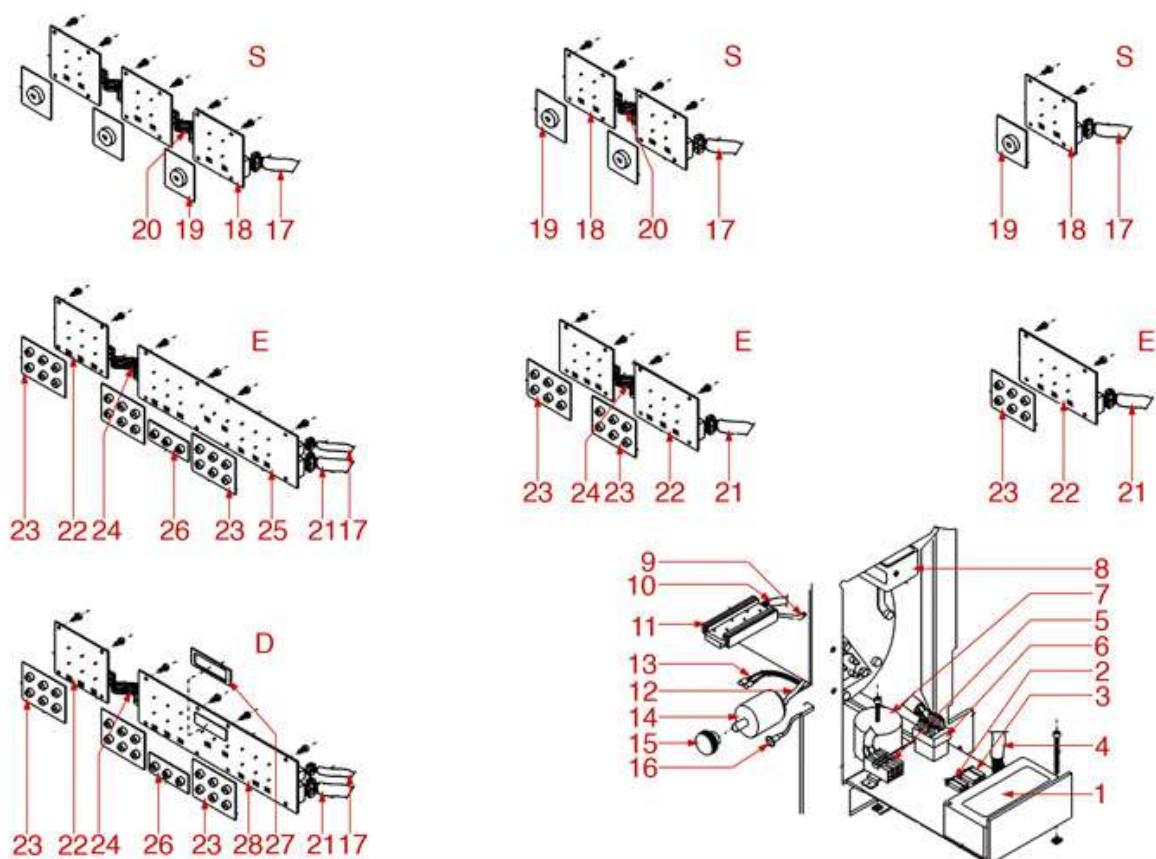

100

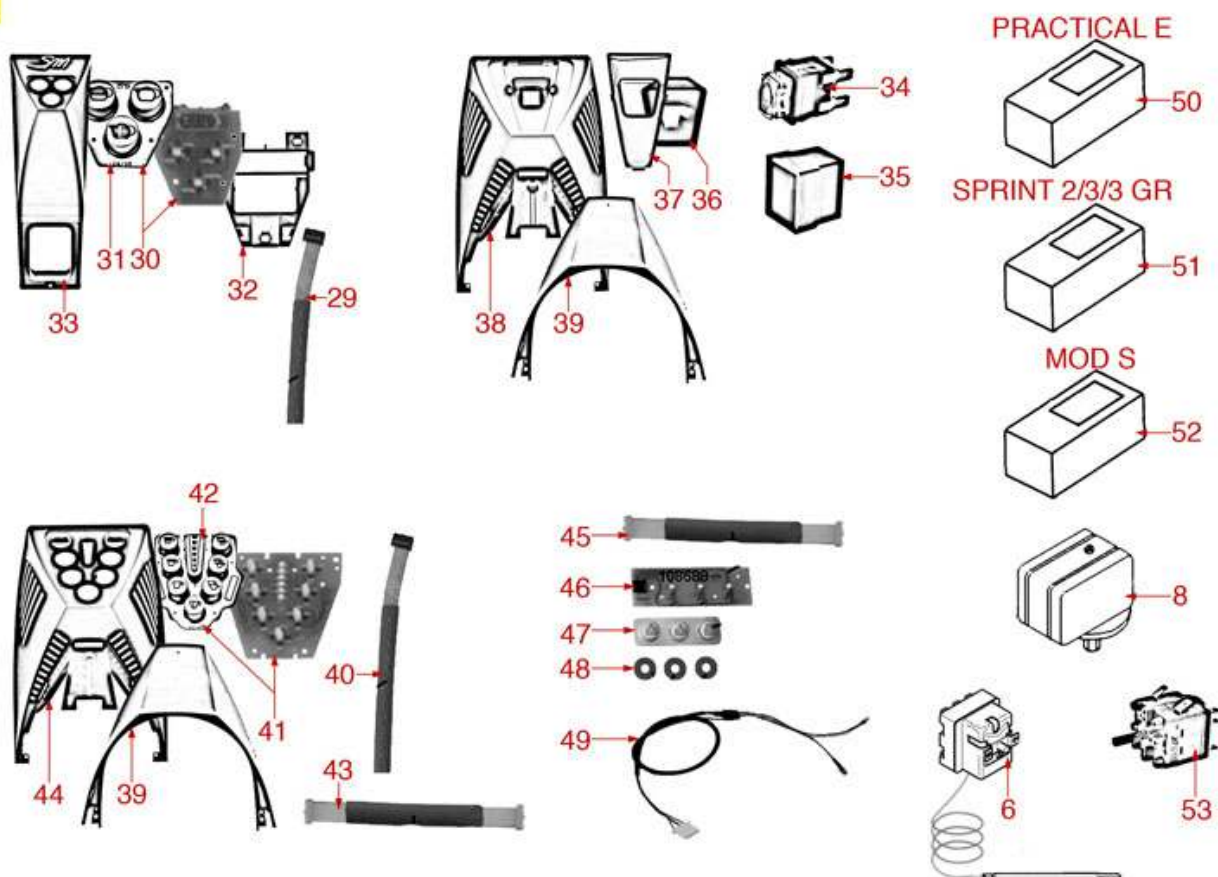

SM3002



SAN MARCO



Position	LF code no.	Description
1	1054401	DOSING CONTROL BOX 2-3-4 GROUPS 230V
1	1054402	DOSER CONTROL BOX 2-3-4 GROUPS 230V
1	1054403	DOSING CONTROL BOX 2-3-4 GROUPS 230V
6	1444509	THREE-PHASE THERMOSTAT 169°C
8	1320531	PRESSURE SWITCH P302/6 3-POLES 30A
14	1319807	SELECTOR SWITCH 0-2 POSITIONS 32A 600V
15	1241449	SELECTOR SWITCH KNOB
16	1221003	RED INDICATOR LAMP 24V
18	1319257	PUSH-BUTTON PANEL BOARD 1 BUTTON
19	1319258	PUSH-BUTTON PANEL MEMBRANE 1 BUTTON
22	1319575	PUSH-BUTTON PANEL BOARD 6 BUTTONS
23	1319573	PUSH-BUTTON PANEL MEMBRANE 6 BUTTONS
25	1319576	PUSH-BUTTON PANEL BOARD 15 BUTTONS
26	1319574	PUSH-BUTTON PANEL MEMBRANE 3 BUTTONS
31	1319265	PUSH-BUTTON PANEL MEMBRANE 3 BUTTONS
32	1319267	WATER PUSH-BUTTON PANEL SUPPORT
33	1244006	PLATE FOR WATER PUSH-BUTTON PANEL
34	1319268	WHITE BIPOLAR SWITCH 16A 250V
35	1319266	PUSH-BUTTON SUPPORT
36	1319269	SWITCH BUTTON
37	1244005	CHROME-PLATED COVER PLATE
38	1244007	PLATE FOR PUSH-BUTTON
39	1244004	CHROME-PLATED GROUP COVER PLATE
41	1319254	PUSH-BUTTON PANEL 7 BUTTONS
42	1319270	PUSH-BUTTON PANEL MEMBRANE 7 BUTTONS
44	1244003	PLATE FOR PUSH-BUTTON PANEL
50	1054020	DOSER CONTROL BOX 1 GROUP 230V 50Hz
51	1054015	DOSER CONTROL BOX 2-3-4 GROUPS 230V
53	1057018	SELECTOR SWITCH 0-2 POSITIONS 16A 250V